

# CABLE-GRIP™ AND STOPPER-GRIP™ TERMINATIONS

Capable of Holding Cable to its Rated Breaking Strength

## PRODUCT DESCRIPTION

PMI's CABLE-GRIP and STOPPER-GRIPs are ideal for getting a quick grip on wire rope and Electro-Opto-Mechanical (EOM) cables. The helical wire design permits easy installation anywhere along the length of the cable and does not require access to the cable end. PMI Grips hold to rated breaking strength of the cable.

A wide range of grips are available in various diameters and lengths to support a broad variety of applications:

- CABLE-GRIP: Terminations for cable diameters less than 25 mm (1 inch)
- STOPPER-GRIP: Terminations for cable diameters greater than 25 mm (1 inch)

## APPLICATIONS

- De-tensioning of cable line
- Routine and/or Emergency cable handling
- Temporary hang-offs
- Mooring systems
- Strain relief at connection points
- Towed side scan sonars
- Towed cable systems
- CTD's, Rosettes
- ROV's
- Aquaculture - device attachments to netting

## FEATURES AND BENEFITS

- Field-installable wrap-on design with no tools or cable preparation required to save time and money
- Range of diameters from 3 mm (0.125") to 152 mm (6.0") and many with length options
- Helical gripping secures firmly to the cable to its rated breaking strength
- Thimbles available for added termination strength
- Load is transferred gradually from cable to termination without damaging cable due to stress concentration
- Compatible with many jacketed and synthetic strength members
- Standard grips are made of galvanized steel
  - Optional stainless steel, available upon request
  - Additional strain/bend relief protection to assist with minimizing kinking

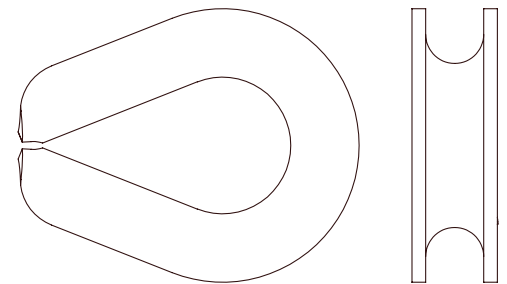

## CABLE-GRIP AND STOPPER-GRIP TERMINATIONS

CABLE-GRIP and STOPPER-GRIP Terminations are built to close tolerances. To ensure satisfactory results, specify:

- Cable or rope diameter
- Lay direction of outer strength member
- Rated breaking strength
- Construction and/or type

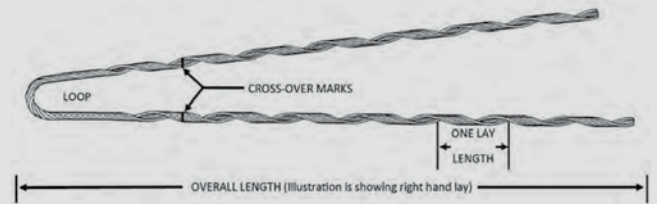

A partial list of CABLE-GRIP and STOPPER-GRIP Terminations are shown in the table. For diameters and length options, and for use on jacketed and synthetic cables, please contact PMI.

### STANDARD CABLE-GRIP TERMINATION FOR DIAMETERS UNDER 25 mm (1"): OTHER SIZES AVAILABLE UPON REQUEST

PMI #	CABLE RANGE	LENGTH	LAY DIRECTION	LOOP DIAMETER	RHS*
9100037	6.0 - 6.5 mm (0.238 - 0.256")	673 mm (26.5")	LHL	38 mm (1.50")	41.4 kN (9,300 lbf.)
9100038	7.7 - 8.3 mm (0.305 - 0.328")	838 mm (33.0")	LHL	44 mm (1.75")	57.8 kN (13,000 lbf.)
9100043	7.9 - 8.5 mm (0.310 - 0.333")	673 mm (26.5")	RHL	38 mm (1.50")	49.8 kN (11,200 lbf.)
9100062	8.9 - 9.6 mm (0.350 - 0.377")	940 mm (37.0")	LHL	44 mm (1.75")	77.8 kN (17,500 lbf.)
9100046	10.3 - 11.0 mm (0.404 - 0.435")	940 mm (37.0")	LHL	51 mm (2.00")	100.5 kN (22,600 lbf.)
9100031	10.8 - 11.6 mm (0.425 - 0.458")	889mm (35.0")	RHL	51 mm (2.00")	93.4 kN (21,000 lbf.)
9100029	11.3 - 12.2 mm (0.446 - 0.481")	940 mm (37.0")	LHL	51 mm (2.00")	100.5 kN (22,600 lbf.)
9100032	12.3 - 13.3 mm (0.486 - 0.523")	1257 mm (49.5")	LHL	51 mm (2.00")	133.0 kN (29,900 lbf.)
9100023	15.4 - 16.6 mm (0.608 - 0.655")	1626 mm (64.0")	LHL	64 mm (2.50")	201.5 kN (45,300 lbf.)
9100053	21.9 - 23.6 mm (0.864 - 0.931")	2121 mm (83.5")	LHL	102 mm (4.00")	213.1 kN (47,900 lbf.)

### STANDARD STOPPER-GRIP TERMINATION FOR DIAMETERS 25 mm (1") AND OVER: OTHER SIZES AVAILABLE UPON REQUEST

PMI #	CABLE RANGE	LENGTH	LAY DIRECTION	LOOP DIAMETER	RHS*
9009364	26.0 - 29.0 mm (1.020 - 1.140")	1753 mm (69")	LHL	89 mm (3.50")	322.9 kN (72,600 lbf.)
9100208	27.3 - 29.4 mm (1.074 - 1.156")	2362 mm (93")	LHL	89 mm (3.50")	266.4 kN (59,900 lbf.)
9100220	30.5 - 32.9 mm (1.201 - 1.294")	1892 mm (74.5")	RHL	89 mm (3.50")	239.8 kN (53,900 lbf.)
9100205	33.0 - 35.5 mm (1.299 - 1.399")	2032 mm (80")	LHL	102 mm (4.00")	282.0 kN (63,400 lbf.)
9100201	37.2 - 40.1 mm (1.464 - 1.577")	2261 mm (89")	LHL	102 mm (4.00")	282.0 kN (63,400 lbf.)
9100219	42.2 - 45.4 mm (1.660 - 1.780")	2591 mm (102")	RHL	102 mm (4.00")	484.4 kN (108,900 lbf.)
9100211	43.4 - 46.7 mm (1.708 - 1.840")	2616 mm (103")	LHL	121 mm (4.75")	484.4 kN (108,900 lbf.)
9100210	45.9 - 49.4 mm (1.806 - 1.945")	2769 mm (109")	LHL	140 mm (5.50")	524.4 kN (117,900 lbf.)
9100217	66.9 - 72.1 mm (2.630 - 2.830")	3327 mm (131")	LHL	127 mm (5.00")	834.0 kN (187,500 lbf.)
9009333	64.1 - 68.1 mm (2.524 - 2.680")	4407 mm (173.5")	LHL	140 mm (5.50")	834.0 kN (187,500 lbf.)

\*RHS= Calculated Rated Holding Strength on typical double-armored steel cable. Holding strength is dependent on cable construction.

### TECHNICAL SUPPORT

If you have questions or concerns about any PMI product, please contact our engineering staff directly.  
 PMI Industries, Inc. | 5300 St. Clair Avenue | Cleveland, Ohio 44103 USA | +1 (216) 881 4914 | sales@pmiind.com

